

Unitech Self- priming Pumps Series 200

APPLICATION:

Applicable for transportation of liquids without content of mechanical alloys in different areas of the food industry. These pumps have the ability to suck from depth up to 6 meters under their own level. Their construction allows reversible depending on the direction of the electric motor.

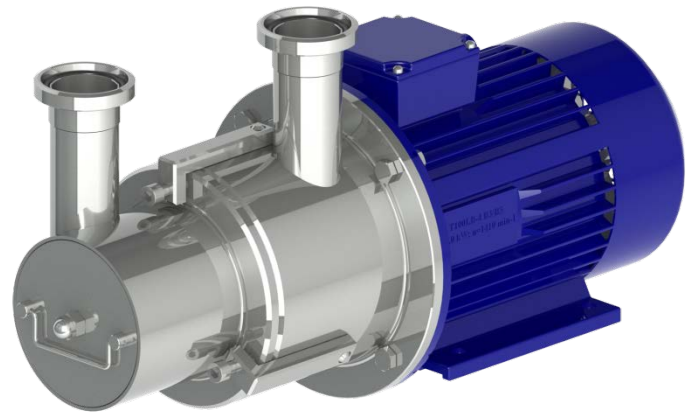

STANDARD EQUIPMENT:

Block pump – directly joined to the shaft of the electric motor.

Standing on heels of the el. motor.

Material AISI 304

Standard Inlet / Outlet: male union joints DIN 11851

OPTIONS:

***K-modification** (mounted on a trolley with Starter)

***Se- modification** (eccentric protective cover on the engine)

***B- modification** (By-pass with safety overflow valve)

***Monophase** - power supply 220V

Material AISI 316

Connection: Garolla, SMS, Macon, Clamp, etc.

***Other Options on Request**

Technical Parameters							
Model	Capacity	Nominal Pressure	Electric Motor		Connection	Temperature	Weight
			kW	RPM			
PVS202	2 m ³ /h	1.5 bar	0.75	1420	male union joints DIN 11851	+2 ÷ +95°C	20 kg
PVS205	5 m ³ /h		1.50	1420			34 kg
PVS210	10 m ³ /h		3.0	1420			53 kg
PVS220	20 m ³ /h		5.5	1420			86 kg
PVS231	35 m ³ /h		11.0	1420			170 kg

Characteristic Curves of the Unitech Self-priming Pumps Series 200

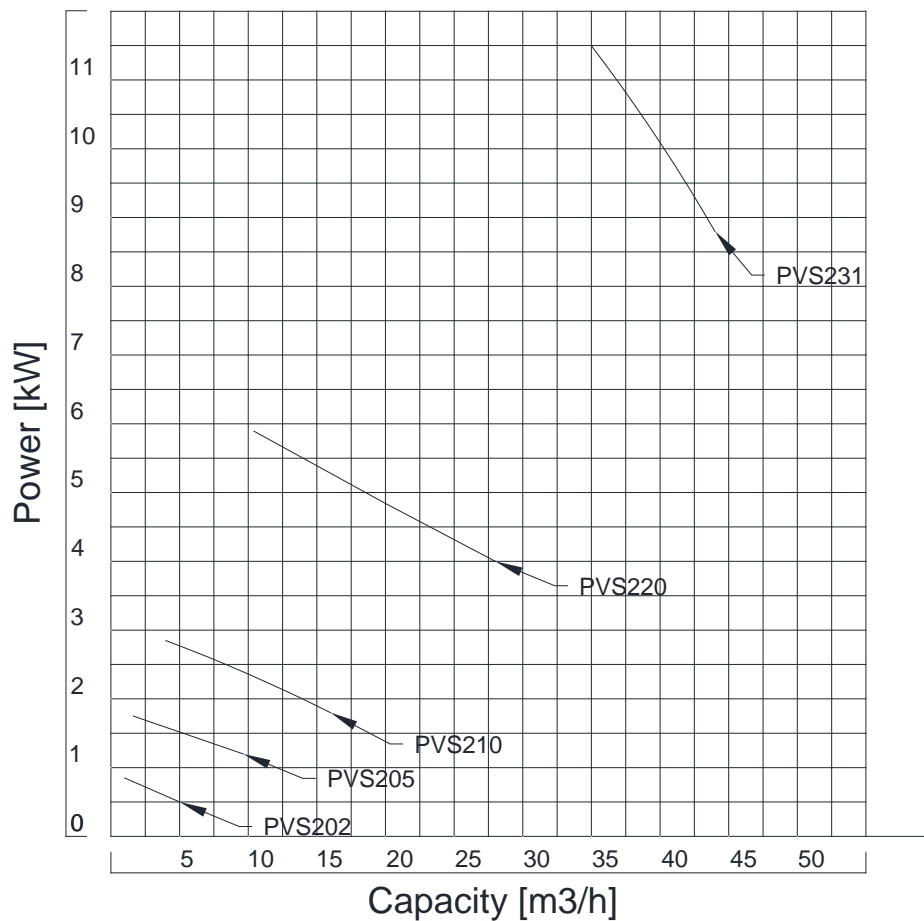
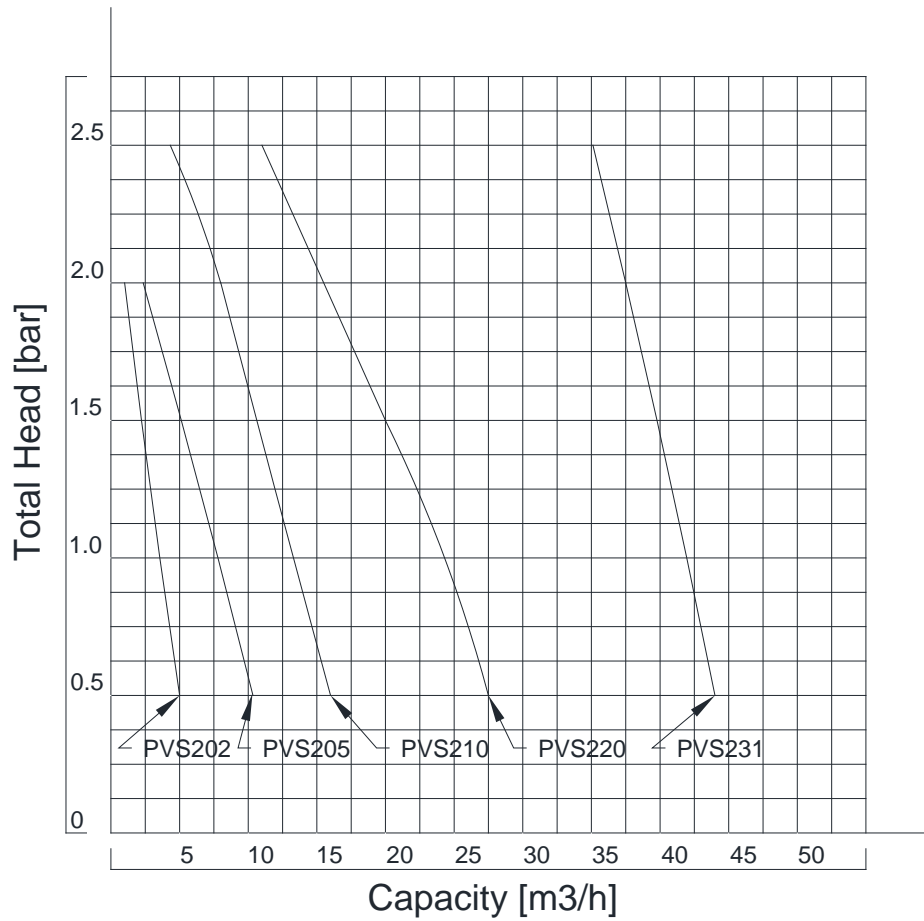

*with fluid – water at temperature 20 °C.
 *with pipes equal with pump's connections.

Dimensions of the Unitech Self-priming Pumps Series 200

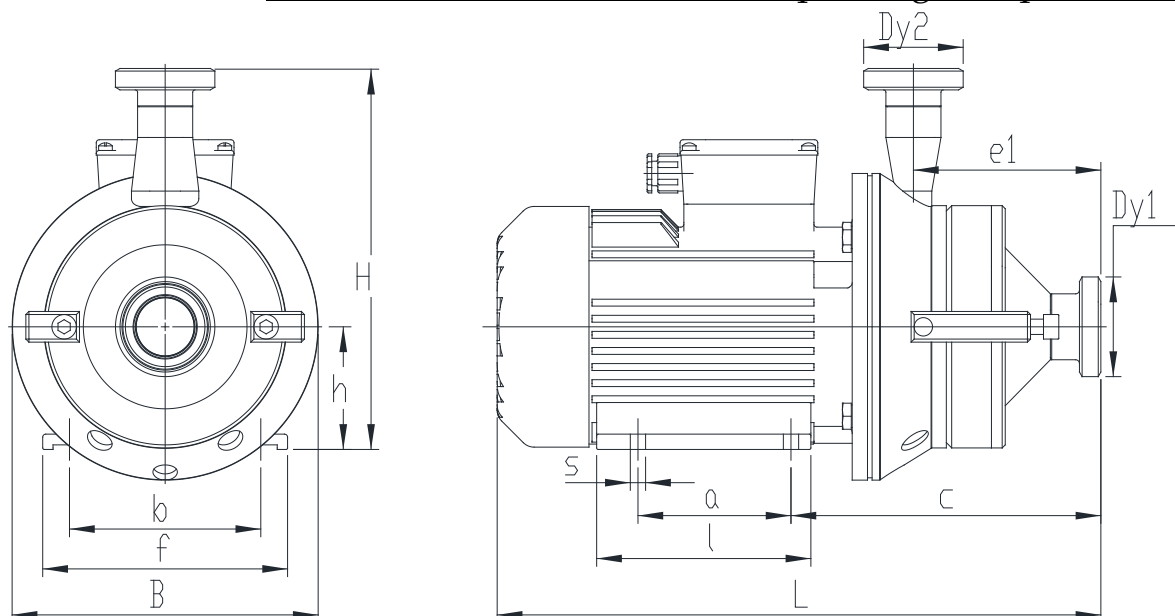

Type	Q	H	P	Dimensions (mm)													T	Sound Level
	m ³ /h	M	kW	Dy	L	B	H	h	e1	c	a	l	b	f	s	kg	dB (A)	
PVS202	2	15	0.75	40	400	200	250	80	120	200	100	140	125	160	10	21	≤ 90	
PVS205	5		1.50		460		260	90	135	216	125	174	140	174		26		

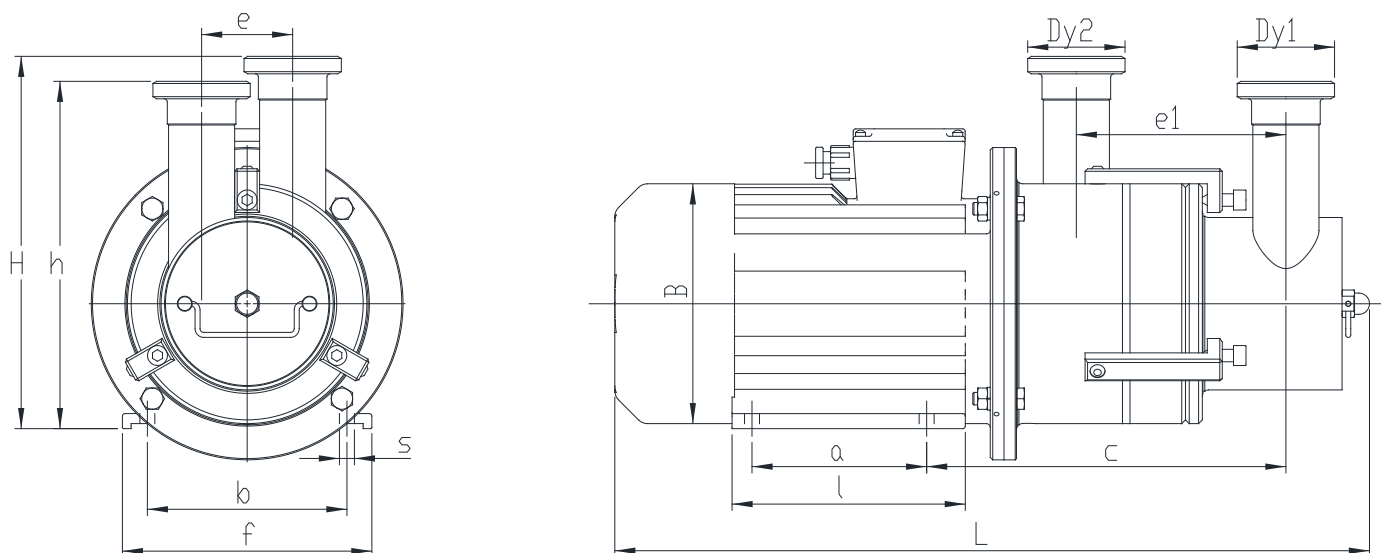

Dimensions, mm															Sound Level
Model	Dy1	Dy2	L	B	H	h	e	e1	c	b	a	f	l	s	dB (A)
PVS210	50	50	605	195	298	278	73	168	288	160	140	200	190	12	≤ 90
PVS220	50	50	665	260	350	310	73	168	314	216	140	255	200	12	

6600 Kardzhali, Bulgaria
 East Industrial Zone
 Post box 187
 Tel: +35936166650
 Fax: +35936166651
 E-mail: unitech@unitech.bg
 Web: www.unitech.bg