

Unitech Screw Pumps Series 300

Models PV300F

APPLICATION:

These pumps have the ability of a delicate straight-streaming transport of a wide range of liquids with or without solid fragments with viscosity up to 150 Pa.s.



STANDARD EQUIPMENT:

***F-modification** (for draining barrels, drums and similar vessels in vertical position)

Material AISI 304/ EPDM

Standard Inlet / Outlet: male union joints DIN 11851

OPTIONS:

***R-modification** – Tripod frame

***Mr-modification** (Gear-motor)

***Mv-modification** (Variable-speed drive)

Material AISI 316

Connection: Garolla, SMS, Macon, Clamp, etc.

***Other Options on Request**

Technical Parameters								
Model	Capacity	Nominal Pressure	Electric Motor		Connection	Temperature	Viscosity	Weight
			kW	RPM				
PV301F	1.0 m ³ /h	4.0 bar	0.55	925	male union joints DIN 11851	+2 ÷ +85°C	up to 150 Pa.s	18 kg
PV301F	1.5 m ³ /h		1.10	1420				20 kg
PV302F	4.0 m ³ /h		1.50	920				41 kg

Characteristic Curves of the Unitech Screw Pumps Series 300 Models PV300F

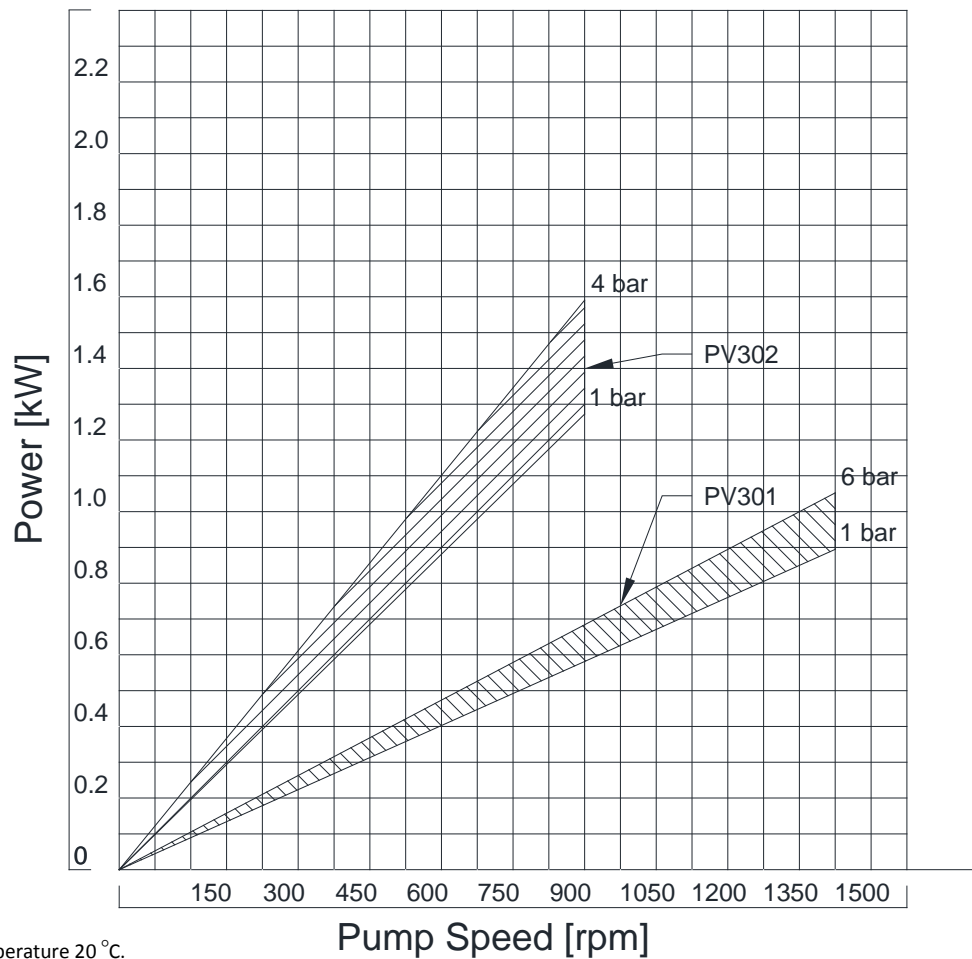
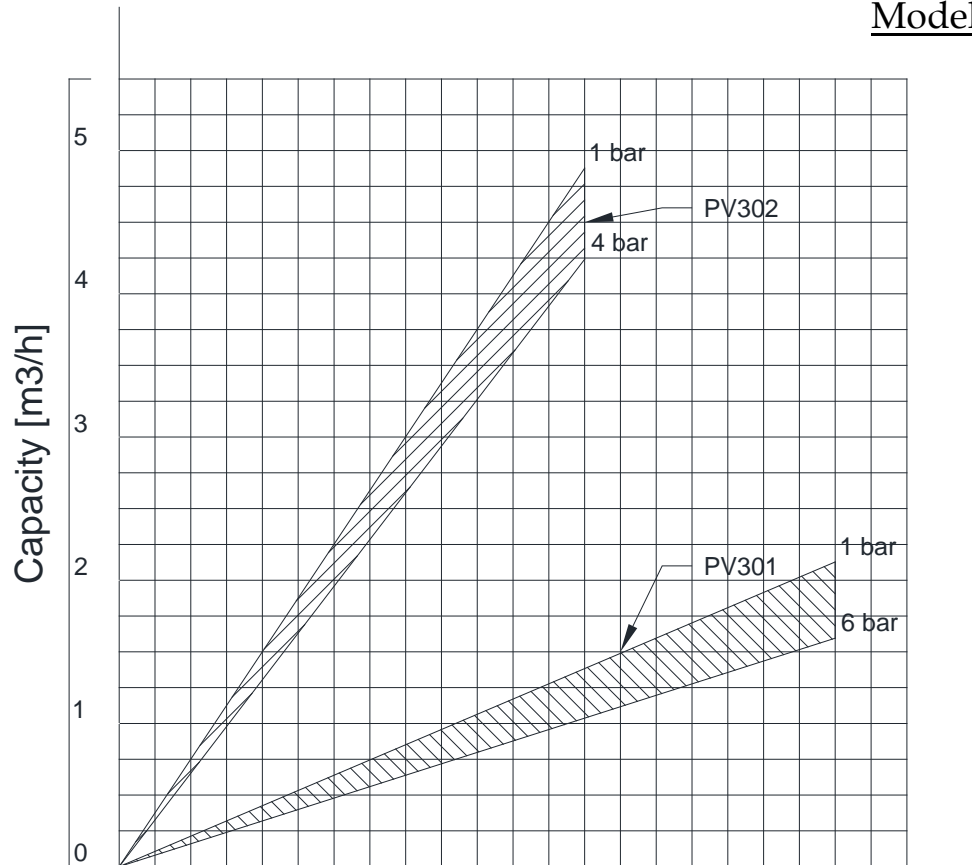

*with fluid – water at temperature 20 °C.
*with pipes equal with pump's connections.

Dimensions of the Unitech Screw Pumps Series 300

Models PV300F

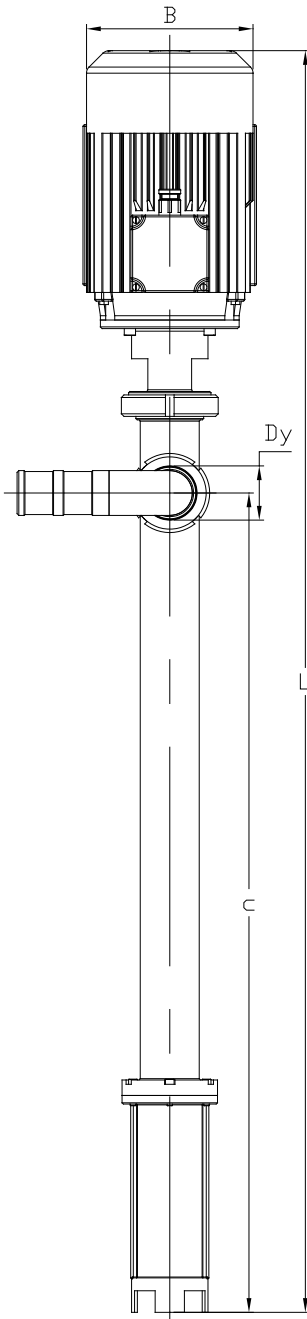
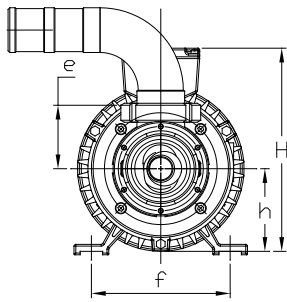

Dimensions, mm								
Model	Dy	L	B	H	h	c	e	f
PV301F	40	1500	160	205	80	1130	65	-
PV302F	50	1465	195	240	95	950	75	160

6600 Kardzhali, Bulgaria
 East Industrial Zone
 Post box 187
 Tel: +35936166650
 Fax: +35936166651
 E-mail: unitech@unitech.bg
 Web: www.unitech.bg